

*art. **0126**

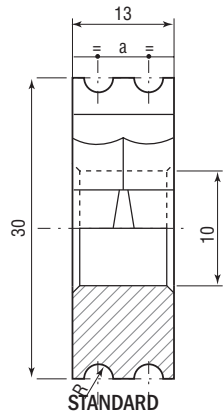
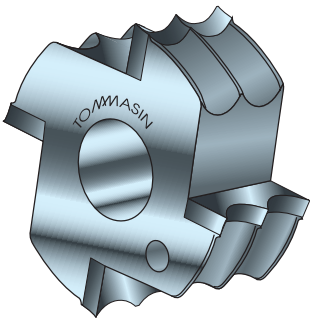

STANDARD
R 2,5 • 3 • 3,5 • 5

Per macchine automatiche.
 (10.000 ÷ 12.000 R.P.M.).
 For automatic machines.

*art. **0126/PCD**

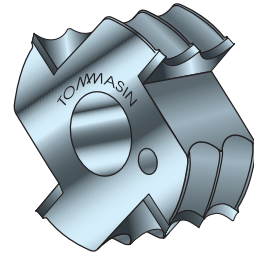

(18.000 / 20.000 R.P.M.).

art. **0127**

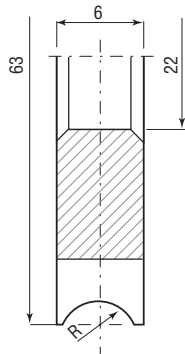
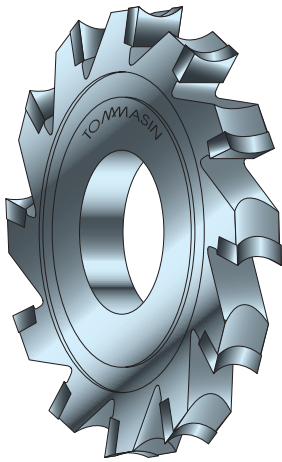

STANDARD
R 2,5 • 3 • 3,5 • 4 • 5

Per fresatrici automatiche.
 (8.000 ÷ 12.000 R.P.M.).
 For automatic milling machines.

*art. **0127/PCD**

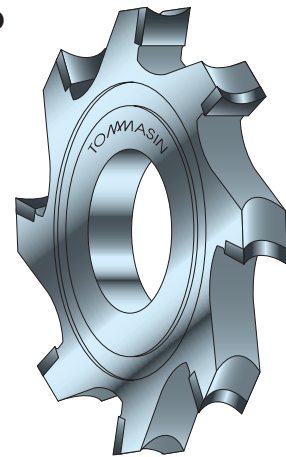

(18.000 / 20.000 R.P.M.).

art. **0128**

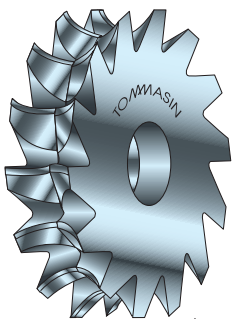

art. **0026**

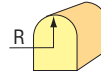
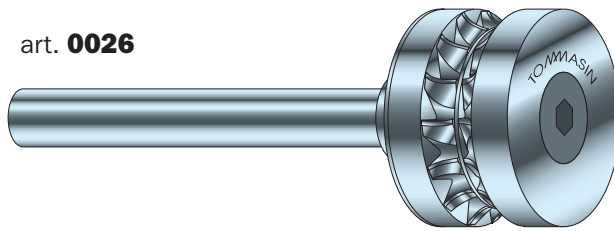

STANDARD

R 1,5 • 2 • 2,5 • 3 • 3,5 • 4

art. **0025**

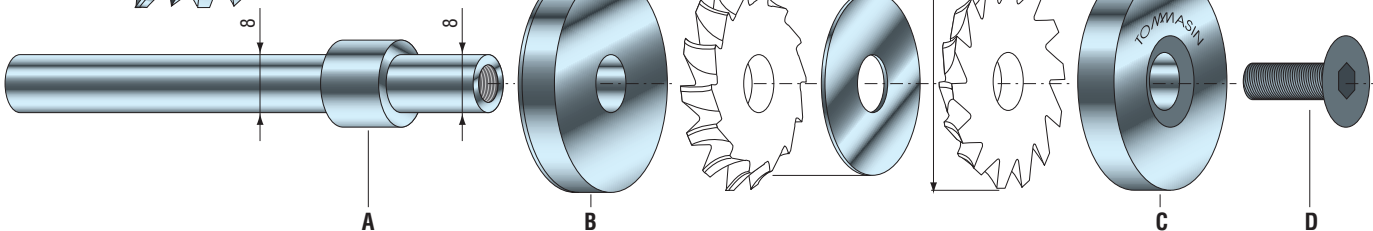

Per fresatrici manuali con albero verticale.

(10.000 ÷ 16.000 R.P.M.).

For manual vertical shaft milling machines.