

art. **0152**

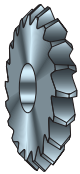

Per asportazione  
For milling

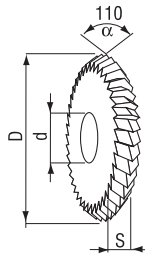

art. **0153**



Per finitura  
For finishing



STANDARD

D	15	12,5	10	8
Z	40	32	26	22
d	4 or 5	4 or 5	-	-
S	2	2	2	2



STANDARD

D	15	12,5
Z	20	16
d	5	5

art. **0199**

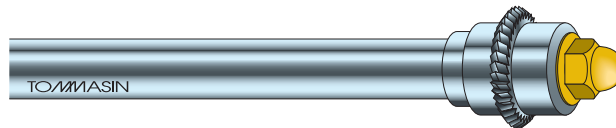
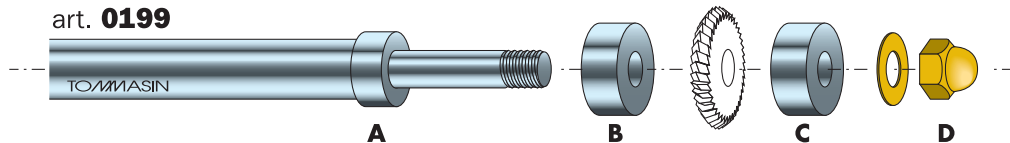

art. **0056**

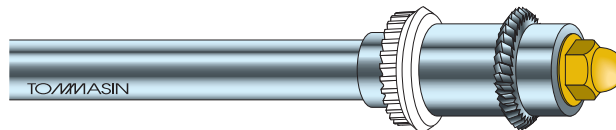

art. **0099**